

REVISION HISTORY				
REV	DESCRIPTION	DATE	REVISED	APPROVED
A0	Drawing release	2014-07-23	Liang Tony	Xiao Shirley
A1	Update drawing	2014-10-16	Liang Tony	Xiao Shirley

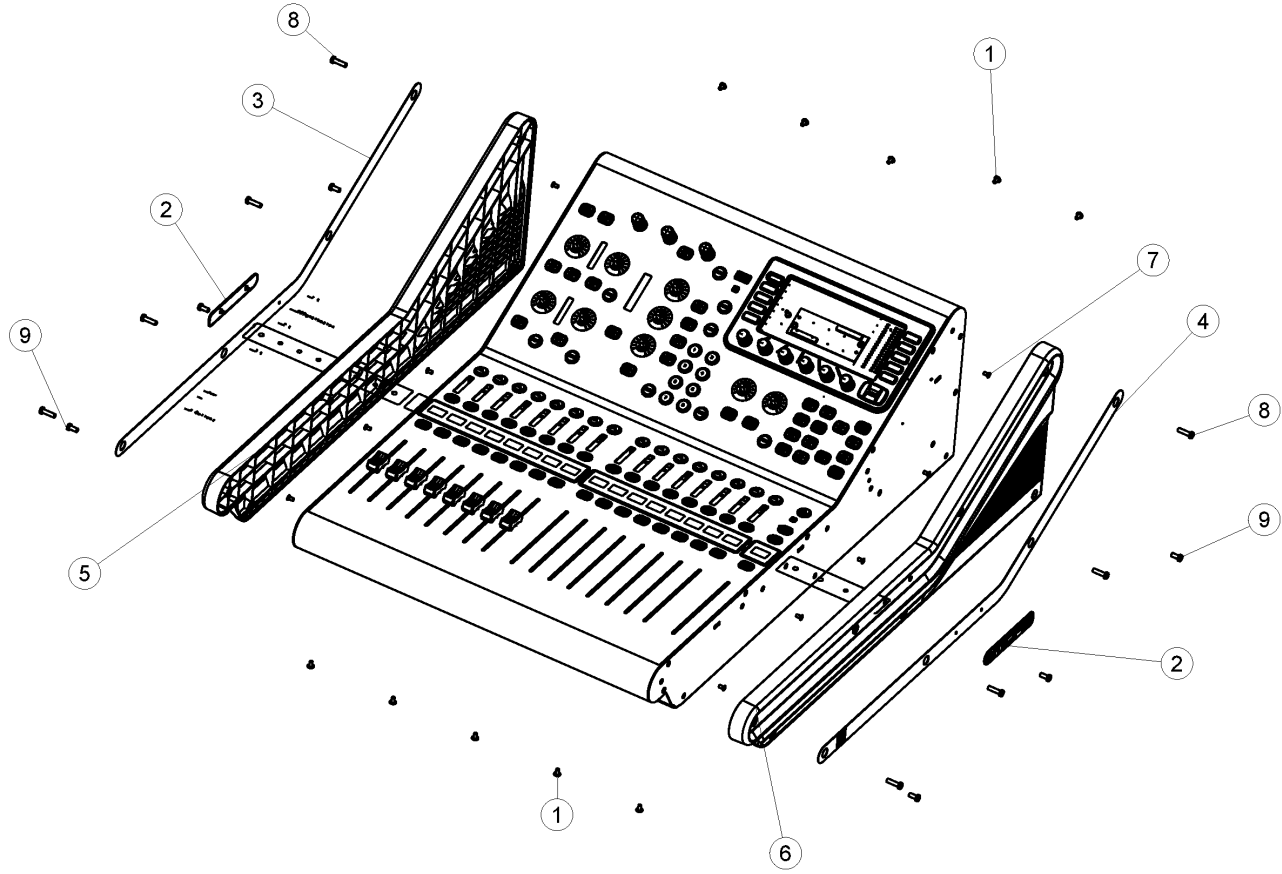

9	F88-00001-07243	6	SC-M4MM9MM/PAN/BA/TORX	
8	F88-00001-07242	8	SC-M4MM115MM/PAN/BA/TORX	
7	F88-00001-07426	10	SC-M3MM8MM/PLAT/BA/TORX	F88-00001-07429
6	G53-00001-04594	1	PLA-POB/S/CAP/CHEEK_RIGHT/BM	022-00001-04601
5	G53-00001-04591	1	PLA-POB/S/CAP/CHEEK_LEFT/BM	022-00001-04595
4	A60-00001-04609	1	MET-POB/S/SHEET_RIGHT/SR	022-00001-04612
3	A60-00001-04608	1	MET-POB/S/SHEET_LEFT/SR	022-00001-04610
2	J05-00001-03026	2	MET-POB/S/LOGO_MIDA/S/SR	022-00001-01591
1	F88-00001-07425	10	M3X9 MM. BINDING_TORX_BLACK_ZINC	F88-00001-07425

ITEM ITEM NUMBER QTY ITEM CODE CONSTRUCTION NUMBER

All information (including drawings and diagrams) contained in this document is the property of MUSIC GROUP LTD. Reproduction without the prior written permission is prohibited. The information is provided in confidence and shall not be used for any other purpose without the prior written permission of MUSIC GROUP LTD. Reproduction without the prior written permission is prohibited.

PROJECT:	POB/S	DRAWN:	Tony Liang	DESCRIPTION:	POB/S-ASM
MATERIAL:		CHECKED:	Ye Hua Ming	DATE:	2014-07-23
APPROVED:	Xiao Shirley	DATE:	2014-07-23	SCALE:	3:10
FINISH:		DATE:	2014-07-23	SIZE:	A2
				DRAWING NUMBER:	014-0001-14575
				REVISION:	A

MUSIC GROUP SHEET 1 OF 1